

INBOARD

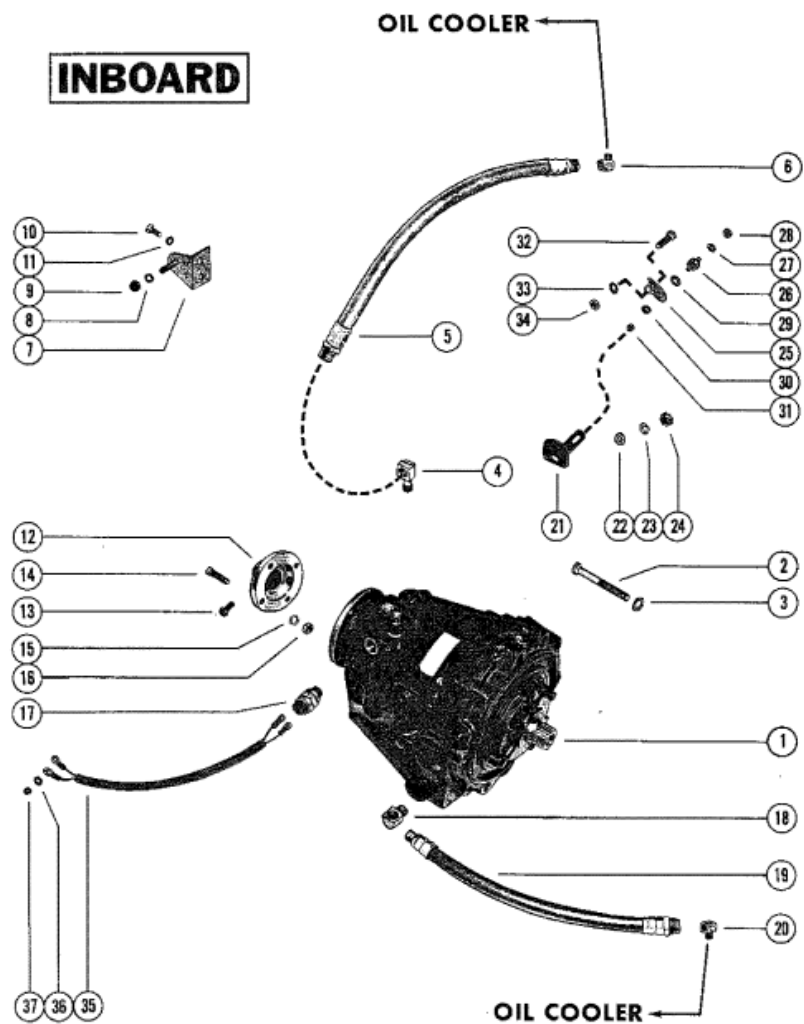

Parts List						
Ref	Class	Part	Description	Qty	Comment	Footnote
1		47810	TRANSMISSION (DIRECT DRIVE)	1		
1		47811	TRANSMISSION (1.523:1 REDUC	1		
1		47812	TRANSMISSION (1.909:1 REDUCTI	1		
1		47813	TRANSMISSION (2.57:1 REDUCT	1		
1		47814	TRANSMISSION (2.909:1 REDUC	1		
2	10	60179	SCREW, TRANSMISSION TO EN	6		
3	13	32993	LOCKWASHER, TRANSMISSION	6		
4	22	63824	ELBOW, HOSE TO TRANSMISSI	1		
5	32	47516	HOSE, TRANSMISSION TO OIL C	1		
6	22	47629	ELBOW, HOSE TO OIL COOLER	1		
7		63815A	2 BRACKET ASSEMBLY, SHIFT CA	1		
8	12	56681	WASHER, SHIFT CABLE STUD	1		
9	11	46438	NUT, SHIFT CABLE STUD	1		
10	10	35585	SCREW, BRACKET TO FLYWHEE	2		
11	13	26992	LOCKWASHER, BRACKET SCREW	2		
12		48386A	1 FLANGE ASSEMBLY (1")	OPT		
12		48387A	1 FLANGE ASSEMBLY (1 1/8")	OPT		
12		48388A	1 FLANGE ASSEMBLY (1 1/4")	OPT		
12		48389A	1 FLANGE ASSEMBLY (1 3/8")	OPT		
12		48390A	1 FLANGE ASSEMBLY (1 1/2")	OPT		
12		57295A	1 FLANGE ASSEMBLY (1 3/4")	OPT		
12		57296A	1 FLANGE ASSEMBLY (2")	OPT		
13	10	60171	SCREW, FLANGE TO PROPELL	2	- SEE NOTE BELOW	
13	10	60170	SCREW, FLANGE TO PROPELL	2	- SEE NOTE BELOW	
13	10	60169	SCREW, FLANGE TO PROPELL	2	- SEE NOTE BELOW	
14	10	60106	SCREW, TRANSMISSION FLAN	4		
15	13	32993	LOCKWASHER, FLANGE SCREW	4		
16	11	22024	NUT, FLANGE SCREW	4		
17		47613	SWITCH, NRUTRAL SAFETY	1		
18	22	63835	ELBOW, HOSE TO TRANSMISSIC	1		
19	32	47516	2 HOSE, OIL COOLER TO TRANSM	1		
20	22	47629	ELBOW, HOSE TO OIL COOLER	1		
21		48515	LEVER, SHIFT - TRANSMISSION	1		
22	12	20722	WASHER, SHIFT LEVER TO TRA	1		
23	13	26993	LOCKWASHER, SHIFT LEVER TC	1		
24	11	20083	NUT, SHIFT LEVER TO TRANSMI	1		
25		48652	ADAPTOR, SHIFT CABLE TO SHII	1		
26	16	48680	STUD, SHIFT CABLE ADAPTOR	1		
27	12	20533	WASHER, ADAPTOR STUD	1		
28	11	46887	NUT, ADAPTOR STUD	1		
29	12	28402	WASHER, ADAPTOR STUD	1		